

Item	Size	d	d1	do	b
1050607	400/160x90	260	8	360	4 x 90°
1050610	560/110x90	210	8	260	4 x 90°
1050611	560/160x90	260	8	360	4 x 90°
1050612	560/200x90	300	8	400	4 x 90°
1050613	560/250x90	350	8	450	6 x 60°
1050614	560/315x90	400	8	515	6 x 60°

**Uponor**

Description  
 INFRA  
 Mounting Dimensions  
 Chamber components  
 Chamber bolt-on saddle

Drawing number  
 Z\_Chamber\_bolt\_on\_saddle\_400\_560

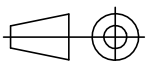

Sheet: 1/1