

4

3

2

1

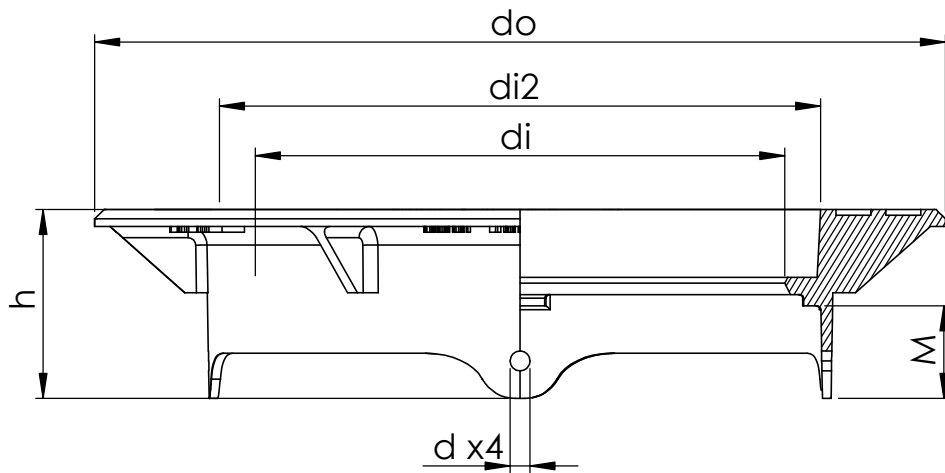

| Item    | Size | d    | di1 | di2 | do  | h   | M  |
|---------|------|------|-----|-----|-----|-----|----|
| 1084215 | 315  | 10,5 | 280 | 315 | 450 | 100 | 49 |
| 1084216 | 500  |      |     | 500 |     |     |    |

**Uponor**

Description  
INFRA  
Mounting dimensions  
Chamber components

Drawing number  
Z\_Chamber\_frame\_round\_315\_500

Sheet: 1/1

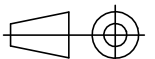

4

3

2

1