

4

3

2

1

F

F

E

E

D

D

C

C

B

B

A

A

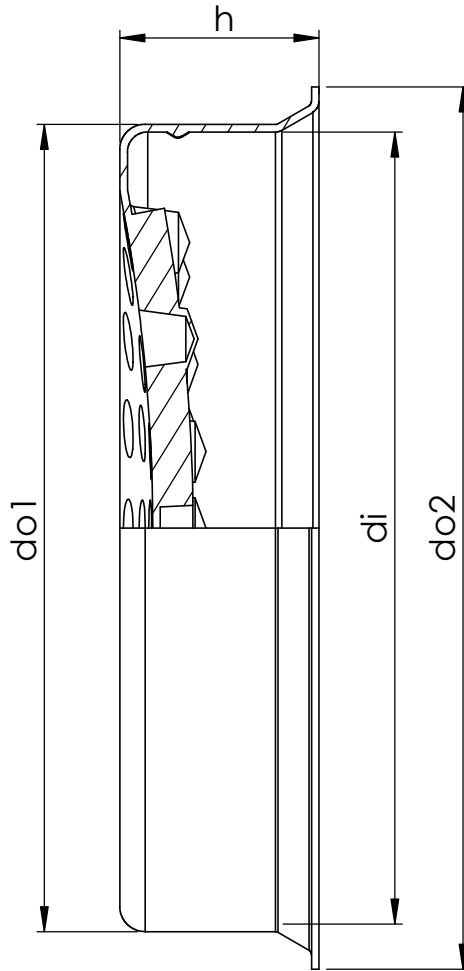

Item	Size	di	do1	do2	h
1002367	315	315	320	350	79

Uponor

Description
 INFRA
 Mounting dimensions
 Chamber components

Drawing number
 Z_Snap-in_lid_for_inspection_chamber

Sheet: 1/1

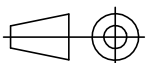

4

3

2

1