

4

3

2

1

F

F

E

E

D

D

C

C

B

B

A

A

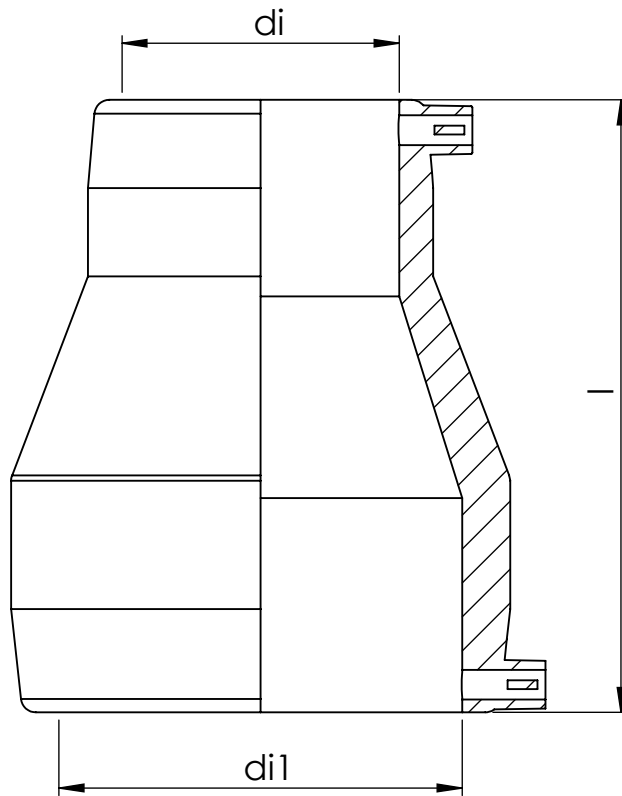

| Item    | Size    | di1 | di  | l   |
|---------|---------|-----|-----|-----|
| 1000427 | 32-20   | 32  | 20  | 85  |
| 1000428 | 32-25   | 32  | 25  | 77  |
| 1000429 | 40-32   | 40  | 32  | 95  |
| 1000430 | 50-32   | 50  | 32  | 100 |
| 1000431 | 50-40   | 50  | 40  | 103 |
| 1000432 | 63-32   | 63  | 32  | 118 |
| 1000433 | 63-40   | 63  | 40  | 144 |
| 1000434 | 63-50   | 63  | 50  | 118 |
| 1000435 | 90-63   | 90  | 63  | 162 |
| 1000436 | 110-90  | 110 | 90  | 178 |
| 1000437 | 125-90  | 125 | 90  | 194 |
| 1000438 | 160-90  | 160 | 90  | 251 |
| 1053759 | 160-110 | 160 | 110 | 243 |
| 1000439 | 180-125 | 180 | 125 | 244 |

**uponor**

Description

INFRA  
Mounting dimensions  
Pressure EF Reducer SDR11 PE 100  
EF FITTINGS

Drawing number

Z\_Pressure\_EF\_Reducer\_SDR11\_PE100

Sheet: 1/1

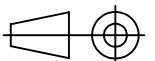

4

3

2

1