

4

3

2

1

F

F

E

E

D

D

C

C

B

B

A

A

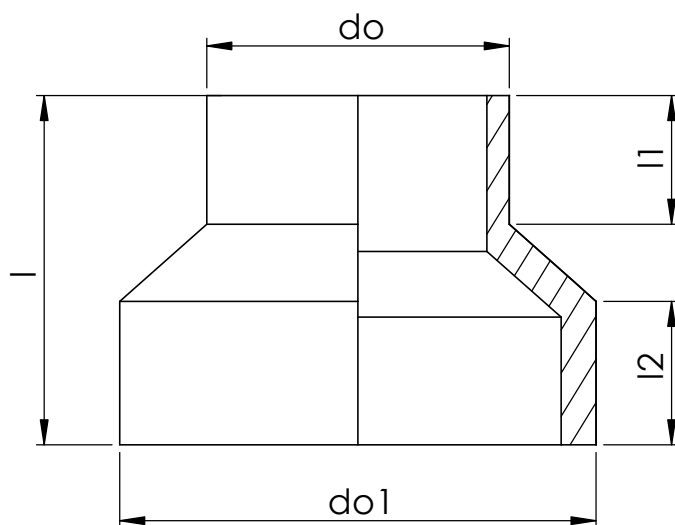

Item	Size	do	do1	l	l1	l2
1076099	140-110	110	140	115	28	35
1076424	200-140	140	200	154	35	50
1068512	250-200	200	250	140	50	58
1073625	315-200	200	315	231	85	95
1068515	315-280	280	315	174	75	80
1076437	355-250	250	355	196	63	86
1076438	355-280	280	355	200	75	86
1076439	355-315	315	355	187	84	86
1073629	400-280	280	400	227	75	95
1068517	400-315	315	400	222	84	95
1076440	400-355	355	400	209	93	95
1076442	500-355	355	500	230	93	60
1068520	500-400	400	500	210	98	60
1068521	500-450	450	500	165	65	60
1137241	560-355	355	560	170	40	65
1073633	560-400	400	560	240	98	53
1076444	560-450	450	560	185	65	57
1068522	560-500	500	560	163	67	57
1076447	630-450	450	630	230	65	58
1068523	630-500	500	630	206	62	63
1089806	710-500	500	710	190	40	84
1068525	710-630	630	710	160	62	65
1137239	800-560	560	800	200	40	85
1089922	800-630	630	800	180	40	85
1068526	800-710	710	800	160	60	62
1068527	900-800	800	900	165	62	62
1068528	1000-900	900	1000	170	55	65

**uponor**

Description  
INFRA  
Mounting dimensions  
Pressure reducer PN10 SDR17 short  
Cold fittings

Drawing number  
Z\_Pressure\_reducer\_PN10\_SDR17\_short

Sheet: 1/1

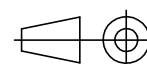

4

3

2

1