

4

3

2

1

F

F

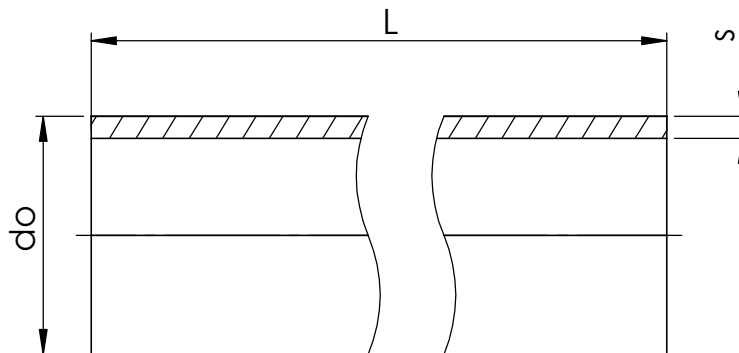

E

E

D

D

Item	Size	do	L	s
1120490	63	63	6	5,8
1120303	63	63	50	5,8
1120491	63	63	100	5,8
1120304	63	63	150	5,8
1120493	75	75	50	6,8
1120305	75	75	75	6,8
1120494	75	75	100	6,8
1120495	90	90	6	8,2
1122373	90	90	12	8,2
1120496	90	90	50	8,2
1139808	90	90	100	8,2
1091465	110	110	12	10
1121505	110	110	12,5	10
1122375	140	140	12	12,7
1089962	160	160	12	14,6
1138460	160	160	Special	14,6
1140903	180	180	12	16,4
1009977	200	200	Special	18,2
1121504	225	225	12,5	20,5
1139497	250	250	Special	22,7
1010066	315	315	Special	28,6
1009978	355	355	Special	32,2
1122300	400	400	12	36,3
1094603	400	400	Special	36,3
1104824	450	450	Special	40,9
1095109	500	500	Special	45,4
1122229	560	560	Special	50,8
1089701	630	630	Special	57,2
1122230	710	710	Special	64,6
1121190	800	800	Special	72,6
1122231	1000	1000	Special	90,8

C

C

B

B

A

A

uponor

Description
INFRA
Mounting dimensions
Pressure water pipe 63-1000 PN16 SDR11
PE100 Water coils&pipes

Drawing number
Z_Pressure_water_pipe_63_1000_PN16_SDR11_PE100_RC

Sheet: 1/1

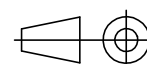

4

3

2

1