

Uponor Comfort Port

EN Installation and operation manual

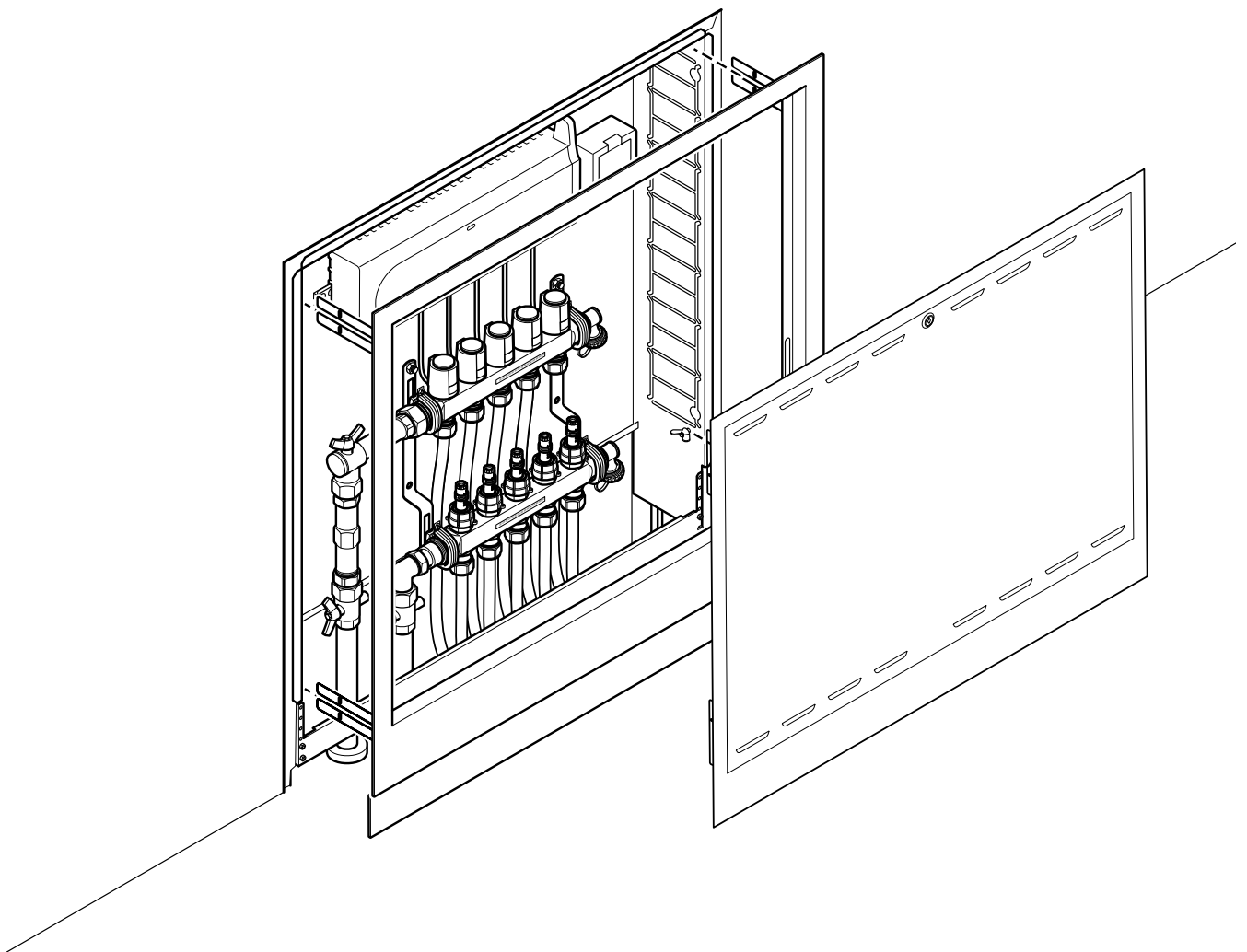

Table of contents

1	Copyright & disclaimer.....	3
2	Preface.....	4
2.1	Safety instructions.....	4
2.2	Interface coordination.....	4
2.3	Correct disposal of this product (Waste Electrical and Electronic Equipment).....	4
3	Uponor Comfort Port system description.....	5
3.1	Operating principle.....	5
4	Install Uponor Comfort Port.....	6
4.1	Prepare for installation.....	6
4.2	Fastening.....	7
4.3	Create primary and secondary connections.....	7
4.4	Start-up.....	8
4.5	Protection against contamination.....	8
4.6	Frame and door installation.....	8
5	Protocol heating circuit pipe lengths and valve settings.....	9

1 Copyright & disclaimer

Uponor has prepared this installation and operation manual and all the content included solely for information purposes. The contents of the manual (including graphics, logos, icons, text, and images) are copyrighted and protected by worldwide copyright laws and treaty provisions. You agree to comply with all copyright laws worldwide in your use of the manual. Modification or use of any of the contents of the manual for any other purpose is a violation of Uponor's copyright, trademark and other proprietary rights.

The presumption for the manual is that the safety measures have been fully complied with and, further, that Uponor Comfort Port system, including any components that are part of such system, covered by the manual:

- is selected, planned and installed and put into operation by a licensed and competent planner and installer in compliance with current (at the time of installation) installation instructions provided by Uponor as well as in compliance with all applicable building and plumbing codes and other requirements and guidelines;
- has not been (temporarily or continuously) exposed to temperatures, pressure and/or voltages that exceed the limits printed on the products or stated in any instructions supplied by Uponor;
- remain in its originally installed location and is not repaired, replaced or interfered with, without prior written consent of Uponor;
- is connected to potable water supplies or compatible plumbing, heating and/or cooling products approved or specified by Uponor;
- is not connected to or used with non-Uponor products, parts or components except for those approved or specified by Uponor; and
- does not show evidence of tampering, mishandling, insufficient maintenance, improper storage, neglect or accidental damage before installation and being put into operation.

While Uponor has made efforts to ensure that the manual is accurate, Uponor does not guarantee or warrant the accuracy of the information contained herein. Uponor reserves the right to modify the specifications and features described herein, or discontinue manufacture of the Uponor Comfort Port products described at any time without prior notice or obligation. The manual is provided "as is" without warranties of any kind, either expressed or implied. The information should be independently verified before using it in any manner.

To the fullest extent permissible, Uponor disclaims all warranties, expressed or implied, including, but not limited to, the implied warranties of merchantability, fitness for particular purpose and non-infringement.

This disclaimer applies to, but is not limited to, the accuracy, reliability or correctness of the manual.

Under no circumstances shall Uponor be liable for any indirect, special, incidental or consequential damages or loss that result from the use of or the inability to use the materials or information in the manual, or any claim attributable to errors, omission or other inaccuracies in the manual, even if Uponor has been advised of the possibility of such damages.

This disclaimer and any provisions in the manual do not limit any statutory rights of consumers.

2 Preface





This installation and operation manual describes how to install and operate the components of the system.

The manual shows an example of an Uponor Comfort Port connection variant. Information about other variations, as well as further technical data can be found in the "Uponor Comfort Port Technical Information".

2.1 Safety instructions

Warnings used in this manual

The following symbols are used in Uponor documentation to indicate special precautions when installing and operating any Uponor equipment:

	DANGER Hazard with high level of risk. Ignoring dangers can result in death or serious injury.
	Warning! Risk of injury. Ignoring warnings can cause injury or damage components.
	Caution! Ignoring cautions can cause malfunctions.
	Note Important information to the section in the manual.

Power

	Warning! The Uponor system uses 50 Hz, 230 V AC power. In case of emergency, immediately disconnect the power.
---	--

Technical constraints

	Caution! To avoid interference, keep installation/data cables away from power cables of more than 50 V.
---	---

Safety measures



Conform to the following measures when installing and operating any Uponor equipment:

- Read and follow the instructions in the installation and operation manual.
- Installation must be performed by a competent person in accordance with local regulations.
- It is prohibited to make changes or modifications not specified in this manual.
- All power supplies must be switched off before starting any wiring work.
- Do not use water to clean Uponor components.
- Do not expose the Uponor components to flammable vapours or gases.

Uponor cannot accept any responsibility for damage or breakdown that can result from ignoring these instructions.

2.2 Interface coordination

Before the installation work begins, a clear interface discussion between the trades involved and the construction management must be carried out.

	DANGER Danger to life from electric current: Touching live components may pose a danger to life. All electrical installations should only be carried out by authorised electricians.
	Warning! Risk of injury due to the high weight of the station: Always wear safety shoes during the assembly. Uponor Comfort Ports can be of considerable weight, depending on the configuration. If the station falls over, this could lead to injuries, particularly to the feet.
	Warning! Leaking connections can cause material damage: Hydraulic connections may become loose and may cause leakages during installation or transport. For this reason, check all connections before commissioning and tighten them if necessary.

2.3 Correct disposal of this product (Waste Electrical and Electronic Equipment)

	Note Applicable in the European Union and other European countries with separate collection systems
---	---



This marking shown on the product or its literature indicates that it should not be disposed with other household waste at the end of its working life. To prevent possible harm to the environment or human health from uncontrolled waste disposal, please separate this from other types of wastes and recycle it responsibly to promote the sustainable reuse of material resources.

Household users should contact either the retailer where they purchased this product, or their local government office, for details of where and how they can take this item for environmentally safe recycling.

Business users should contact their supplier and check the terms and conditions of the purchase contract. This product should not be mixed with other commercial wastes of disposal.

3 Uponor Comfort Port system description

Uponor Comfort Port is a prefabricated cabinet ideally suited for use in multifamily houses or large residential buildings due to enormous time and cost savings. It is available in two different versions, in-wall (IW) and on-wall (OW) mounting, for all common system installations and installation situations.

The ready-to-install cabinet is delivered to the construction site ready for installation according to customer specifications. Upon request

they can also be delivered with specific valves, heat meters and with components from the Uponor Smatrix room temperature control system, both wired and as a flexible and convenient radio solution.

Pre-assembly in the Uponor plant brings many benefits and also significantly reduces the risk of installation errors on site.

3.1 Operating principle

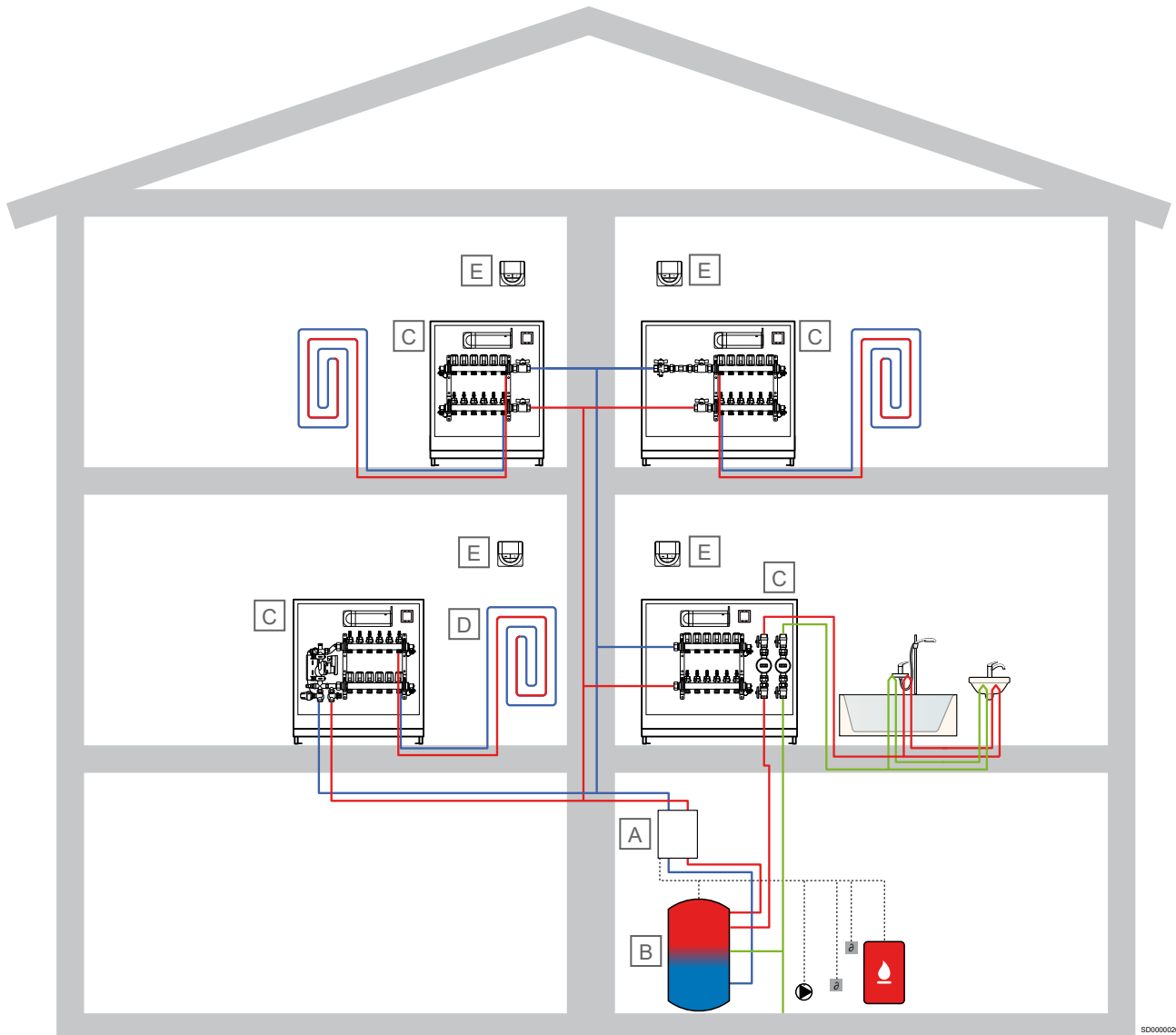

- A Boiler
- B Buffer tank
- C Uponor Comfort Port
- D Underfloor heating
- E Room thermostat

4 Install Uponor Comfort Port

4.1 Prepare for installation



Before the installation, the available dimensions of the recess space (in-wall-mounted cabinet) or the space requirements on the wall (on-wall-mounted cabinet) must be checked.

In addition, check to what extent the feet of the distribution cabinet must be adjusted to fit with the planned flooring construction height.

Corresponding cabinet dimensions and required recess dimensions are shown in the tables below.



Caution!

With the setting of the in-wall-mounted cabinet, in particular in walls made from drywall, attentions must be paid to the installation depth of any possible heat meters (≥ 95 mm).

Uponor Comfort Port IW 110 and 80

Uponor Comfort Port IW 110

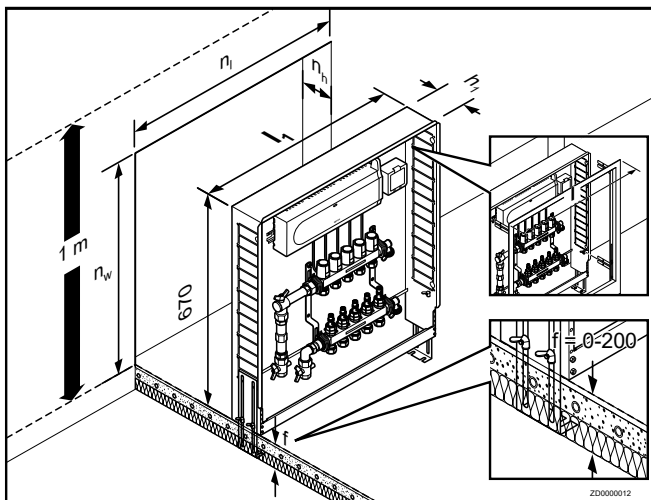

Type (mm)	l_1	h_1	l	n_l	n_w	n_h
410/110	410	110	443	450	690+f	110-150
510/110	510	110	543	550	690+f	110-150
610/110	610	110	643	650	690+f	110-150
760/110	760	110	793	800	690+f	110-150
910/110	910	110	943	950	690+f	110-150
1060/110	1060	110	1093	1100	690+f	110-150
1210/110	1210	110	1243	1250	690+f	110-150
1510/110	1510	110	1543	1550	690+f	110-150

Uponor Comfort Port IW 80

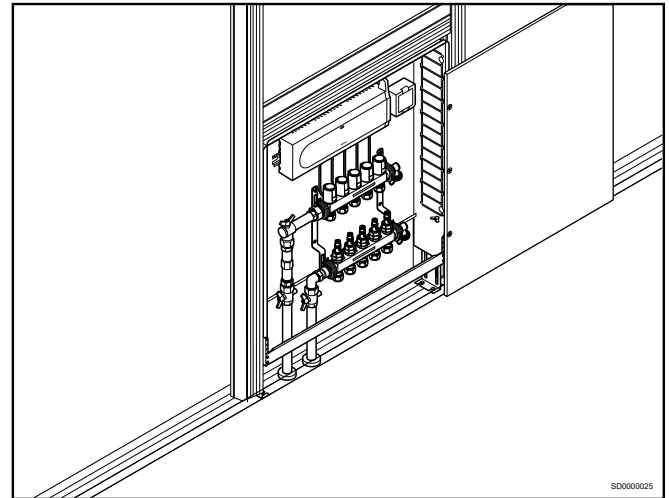

Type (mm)	l_1	h_1	l	n_l	n_w	n_h
410/80	410	80	443	450	690+f	80-120
510/80	510	80	543	550	690+f	80-120
610/80	610	80	643	650	690+f	80-120
760/80	760	80	793	800	690+f	80-120
910/80	910	80	943	950	690+f	80-120
1060/80	1060	80	1093	1100	690+f	80-120
1210/80	1210	80	1243	1250	690+f	80-120
1510/80	1510	80	1543	1550	690+f	80-120

Uponor Comfort Port OW 140

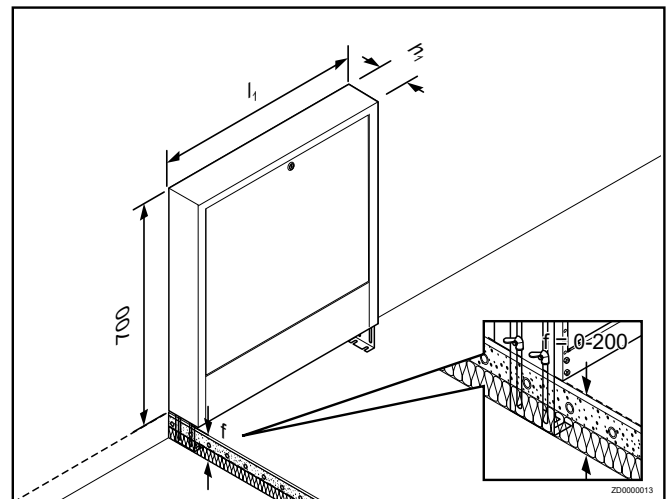

Type (mm)	l_1	h_1
410/140	410	140
510/140	510	140
610/140	610	140
760/140	760	140
910/140	910	140
1060/140	1060	140
1210/140	1210	140
1510/140	1510	140

4.2 Fastening

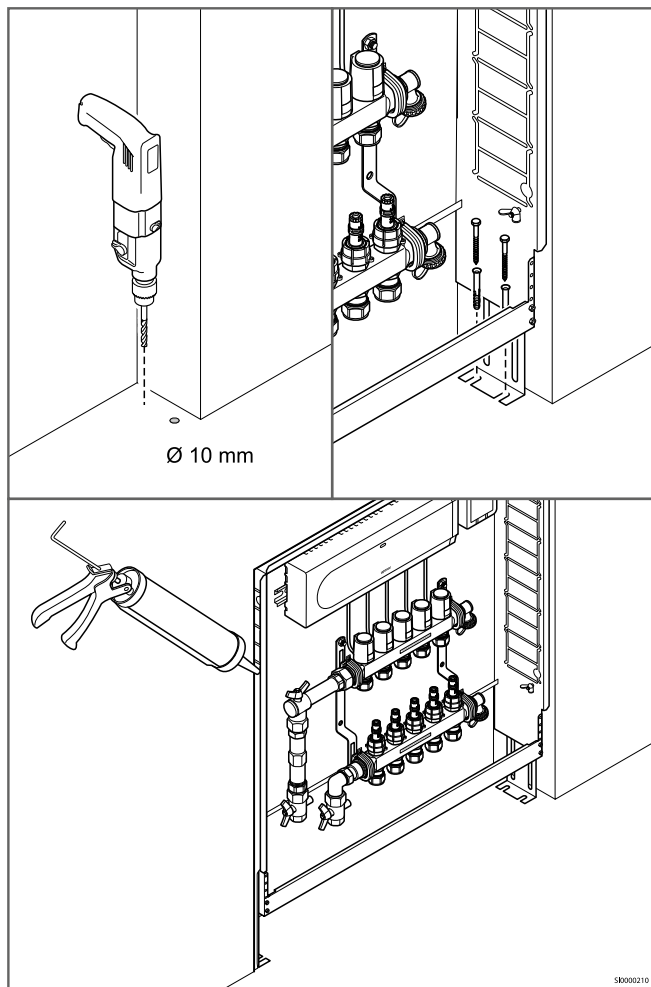

Uponor Comfort Port IW must be screwed to the supporting subsurface.

In addition, the cabinet will be fixed in the wall niche.

Uponor Comfort Port OW will be fastened directly to the wall.

4.3 Create primary and secondary connections

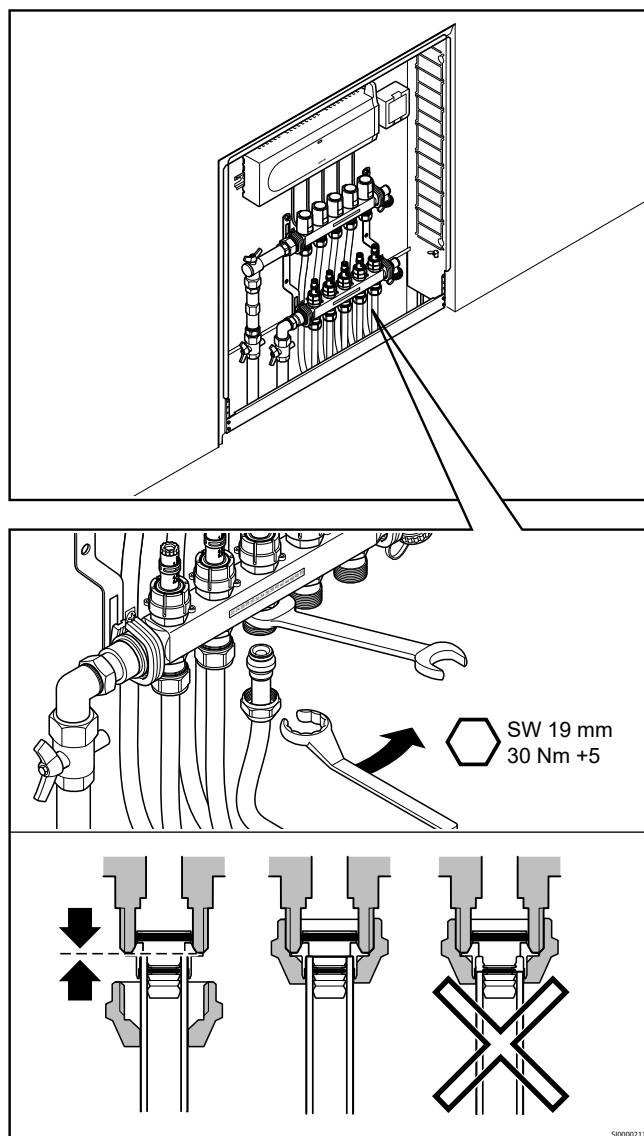

The primary pipe connections are done according to the planning guidelines.

The secondary heating circuit connections are created during the installation of the respective Uponor underfloor heating system. The corresponding instructions for the respective Uponor underfloor heating system must be observed.

4.4 Start-up

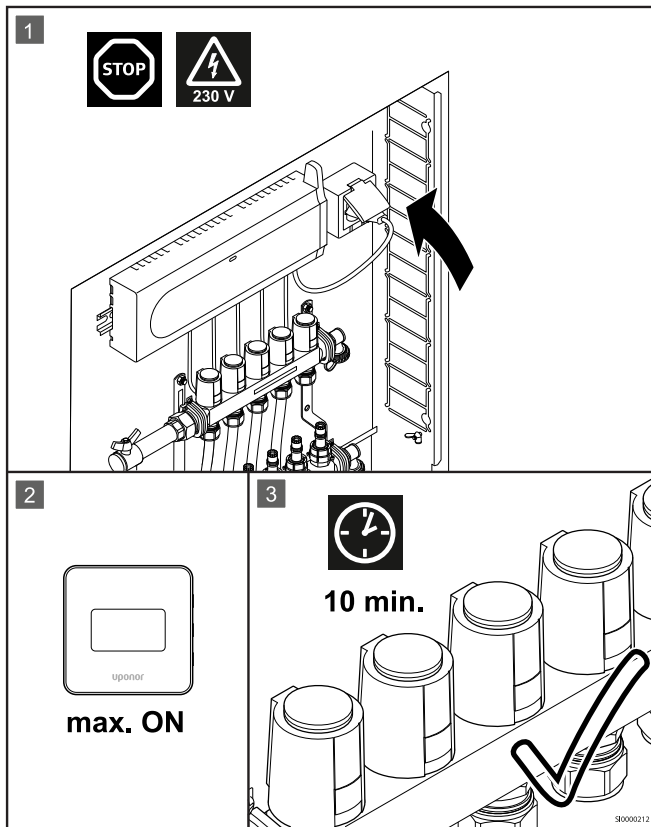

1 Fill, flush, vent and pressure test

The filling, flushing, venting and pressure testing is described in the instructions for the relevant installed heating manifold. To do this, the actuators must be opened without electricity (First-Open-Function) and must not be removed.

2 Connection of the room thermostat

Information about the connection of the room thermostat can be found in the installation and operation manual for the relevant control system.

3 Commissioning of the control system and actuators

With the commissioning of the actuators, the First-Open-Function must be unlocked (actuators must carry current for at least 10 minutes). For this purpose, all room thermostats must be set to the maximum room temperature and must generate heat.

A precise description of the unlocking of the First-Open-Function with the Uponor Smatrix control modules can be found in the operation manual for the Uponor Smatrix room temperature control system under "Test of the actuator".

4.5 Protection against contamination

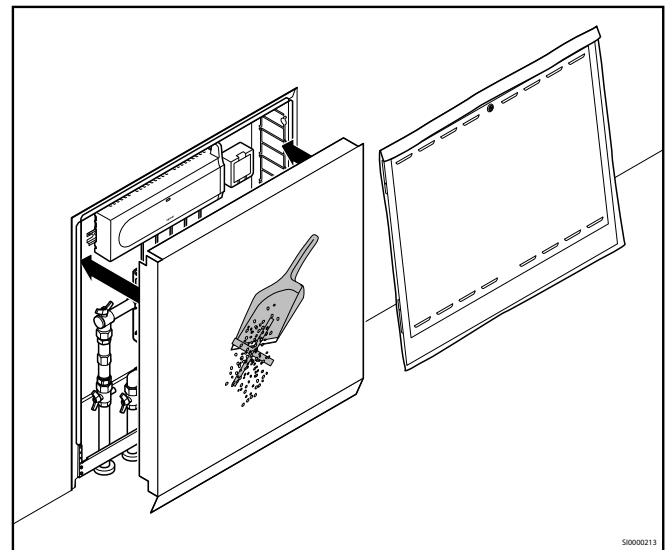

Until the frames and the door are installed, the contents of the cabinet must be protected with a cardboard cover.

The doors and frames must be securely stored in the foil packaging before they are installed at a later point in time.

4.6 Frame and door installation

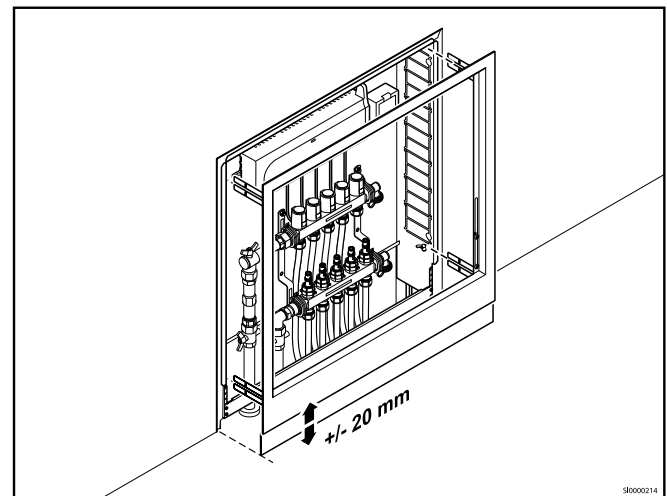

The frame is then placed in the cabinet and is screwed in place through the lateral cover plates. Afterwards, the door can be installed.

The adjustment of the frame to the top of the floor is done by lowering the front panel. To do this, the small screws on the bottom left/right sides are loosened and are then screwed in tight again.



Uponor Vario S LS/FM
Uponor Vario M
Uponor Smatrix
Uponor Base Flexiboard



www.uponor.com/services/download-centre

5 Protocol heating circuit pipe lengths and valve settings



The included instructions about installed heating manifolds, regulation units, as well as other components, must be observed.

Insert the project data in the protocol as follows:

- A** Customer/contruction project
- B** Date
- C** Floor number
- D** Manifold number
- E** Room number
- F** Room name
- G** Heating circuit number
- H** Valve setting/water quantity
- I** Initial meter reading
- J** End meter reading
- K** Effective pipe length
- L** Adjustments to the circuit control valve
- M** Adjustments to the circuit control valve of the pump group
- N** Adjustments to the dynamic valve



Note

After entering the start and end meter readings, this form must be handed over to the planning team.



A

B

C

D

E

1

2

3

4

5

6

7

8

9

10

11

12

F

G

H

I

J

K

L

M

N

SD0000027



Uponor GmbH

Industriestraße 56,
D-97437 Hassfurt, Germany

1094795 02-2019_EN
Production: Uponor/ELO

Uponor reserves the right to make changes, without prior notification,
to the specification of incorporated components in line with its policy of
continuous improvement and development.



www.uponor.com